

ELEMENTARY

Attendance Boundaries



Welcome! Please share with us in the chat:

1. Your name
2. Your child's current school

Current Boundary in Red

Today's Agenda

1. Crowley ISD is GROWING and PLANNING for the Future
2. What is Rezoning?
3. Impacted Campuses
4. Proposed Changes to Elementary Attendance Zones
5. Next Steps and Important Dates

Crowley ISD is GROWING and PLANNING for the Future

Question:

*Of the 90 school districts in DFW,
where does Crowley ISD rank
in new home construction?*



NEW HOME CONSTRUCTION BY DFW SCHOOL DISTRICT

Rank	District	Annual Starts	Annual Closings
1	Northwest	3,742	3,541
2	Denton	2,922	3,263
3	Prosper	2,651	3,190
4	McKinney	2,400	2,389
5	Princeton	2,015	2,198
6	Eagle Mtn-Saginaw	2,110	1,813
7	Forney	1,927	1,732
8	Royse City	1,219	1,518
9	Crowley	1,759	1,510
10	Aubrey	1,157	1,423
11	Melissa	1,150	1,374
12	Frisco	895	1,237
13	Mansfield	788	1,141
14	Celina	1,097	1,126
15	Lewisville	603	1,122
16	Crandall	612	1,121
17	Rockwall	677	1,114
18	Anna	860	1,000
19	Dallas	1,091	994
20	Argyle	655	948
21	Ft. Worth	562	924
22	Garland	979	868
23	Midlothian	750	864
24	Wylie	534	735
25	Mesquite	520	735

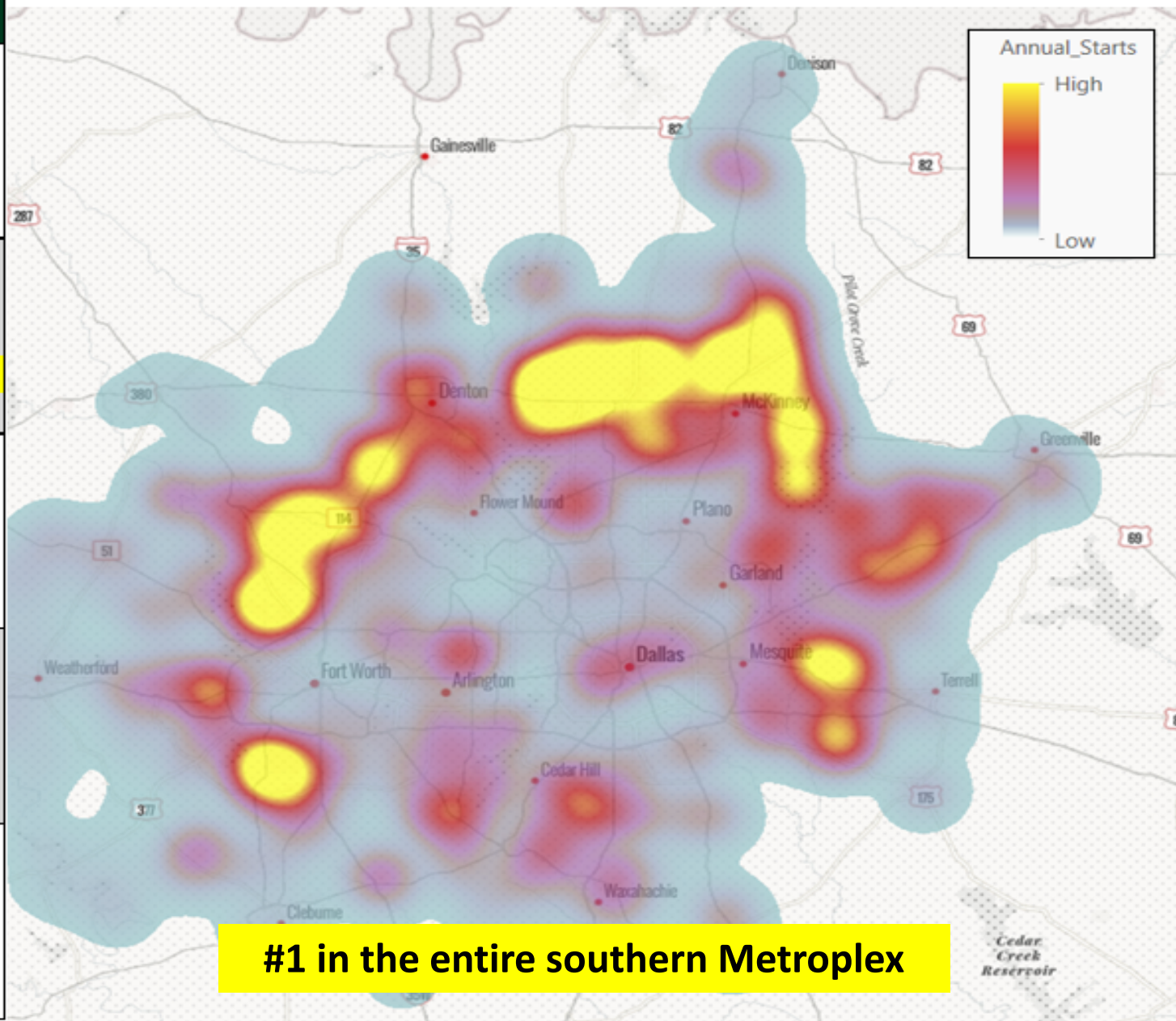



CROWLEY ISD ENROLLMENT GROWTH (PK-12): 15-YEAR HISTORY

Fall Snapshot Date

October 2023: 16,971 students
March 2024: 17,178 students!

Crowley ISD - Enrollment History (PK-12)

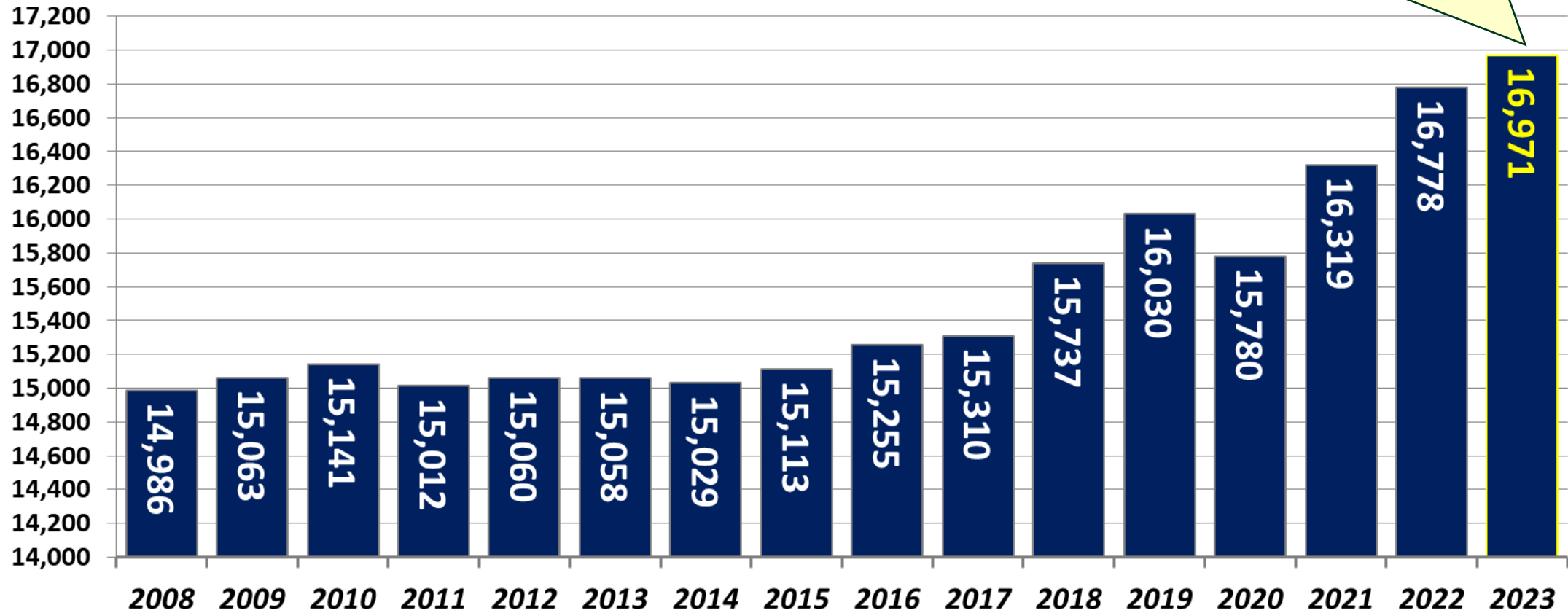



DISTRICT ENROLLMENT PROJECTIONS

FALL 2024-FALL 2033 [3Q23 DRAFT]

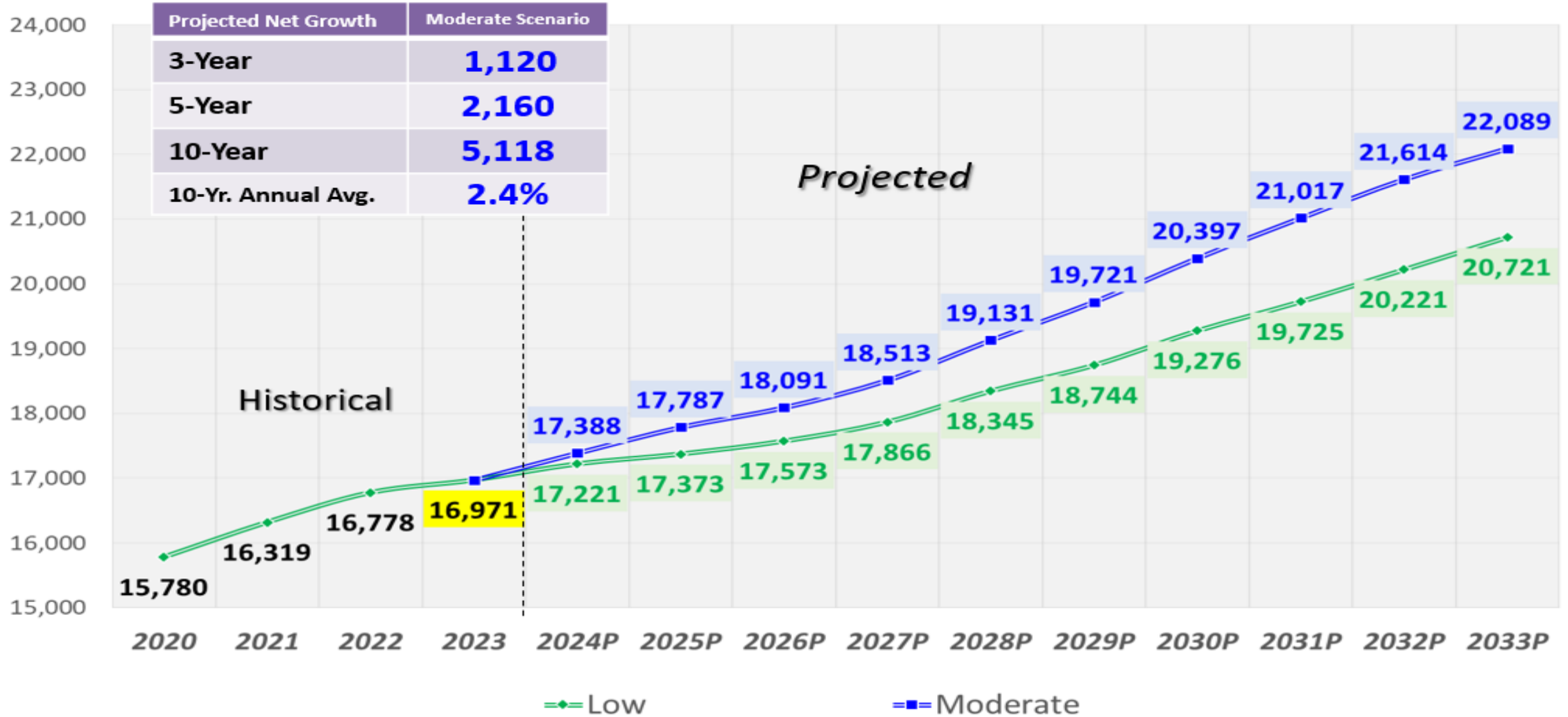



CROWLEY ISD NEW HOME CONSTRUCTION ACTIVITY BY ELEMENTARY ATTENDANCE ZONE 4Q22-3Q23

Annual Starts & Closings

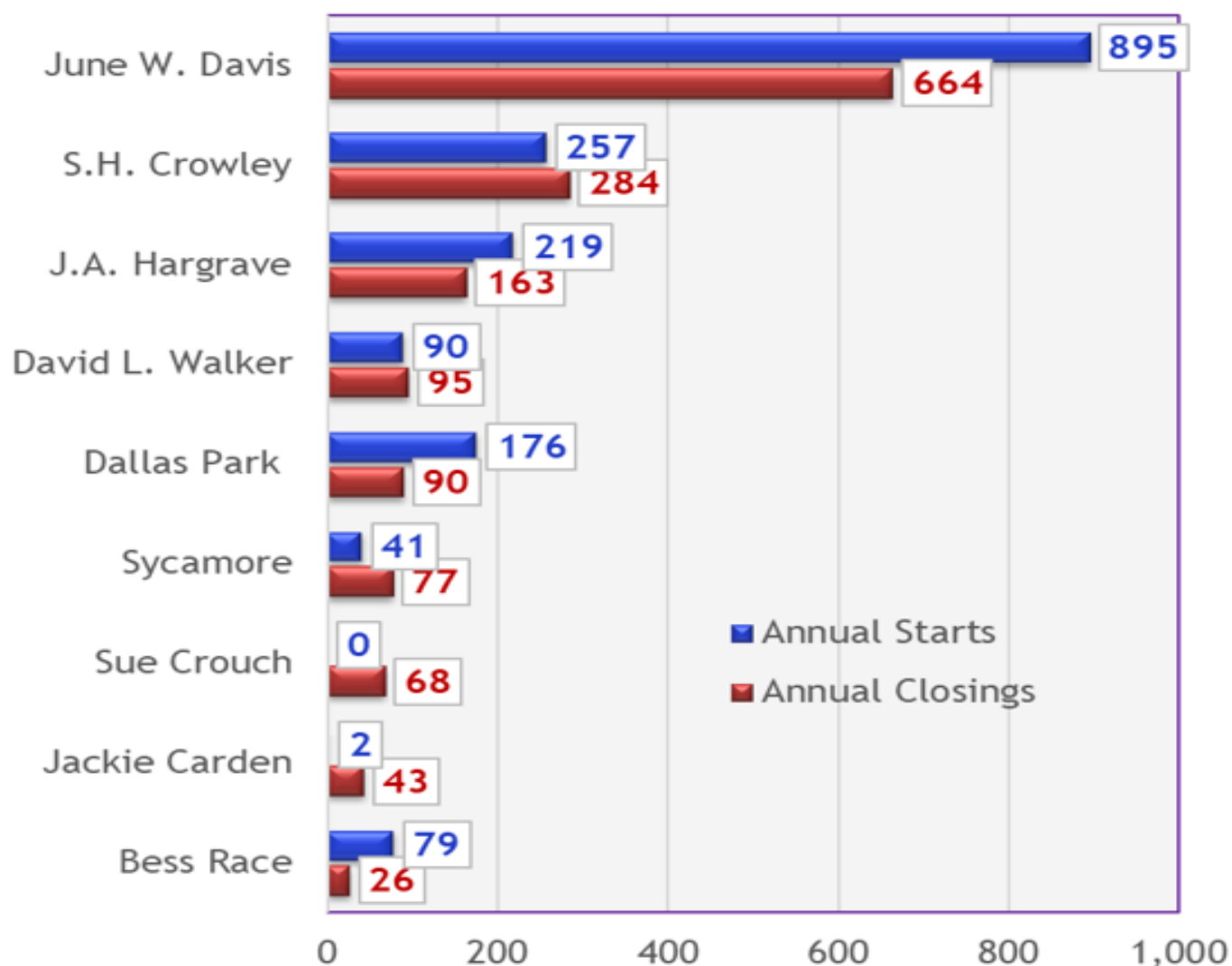

- The June W. Davis, S.H. Crowley, and Hargrave Elementary attendance zones are the most active
- Starts in the Davis zone soar to nearly 900 units; closings top 650 over the past year



Chisholm Trail Pkwy

Davis ES

Llano Springs



Chisholm Trail Ranch-West/South



S.H. Crowley ES

McCart Ave.

Rosemary Ridge

What is Rezoning?

What is Rezoning?

- Redrawing school attendance boundaries
- Maintain safe, equitable distribution of students among different schools
- Necessary as communities grow and new schools are built

What Factors are Considered?

- Capacity of campuses
- Demographic factors
- Projected enrollment
- Geographical proximity
- Transportation patterns
- Minimize the impact on families



Impacted Campuses

Impacted Campuses

2024-2025 School Year

- Dallas Park Elementary
 - *rezoning some current and future students to Mary Harris and Sue Crouch*
- Deer Creek Elementary
 - *rezoning some current and future students to Sidney H. Poynter*
- June W. Davis Elementary
 - *rezoning some current and future students to Sue Crouch and Dallas Park*
- S.H. Crowley Elementary
 - *rezoning some future students to Mary Harris*

2025-2026 School Year

- Bess Race Elementary
 - *rezoning some current and future students to Elementary #17*
- S.H. Crowley Elementary
 - *rezoning some current and future students to Elementary #17*

Your Crowley ISD Bond Dollars At Work!

Providing Safe, Updated and New School Facilities for 21st Century Learning



Construction Anticipated to be
COMPLETED in Fall 2025

\$48.98 Million Investment
408 Jobs Created

Architect
VLK Architects

Construction Manager
Steele & Freeman, Inc. + Post L
Joint Venture

Crowley ISD School Board
Dr. La Tonya Woodson-Mayfield
Gary Grassia
Dr. Mia Hall
Nedra Robinson
Daryl R. Davis, II
June W. Davis
Kelicia Stevenson

Superintendent
Dr. Michael D. McFarland



ELEMENTARY 17
NEW CAMPUS

Elementary School #17

Opening Fall 2025



Proposed Changes to Elementary Attendance Zone

Crowley ISD Elementary Attendance Zones Fall 2022

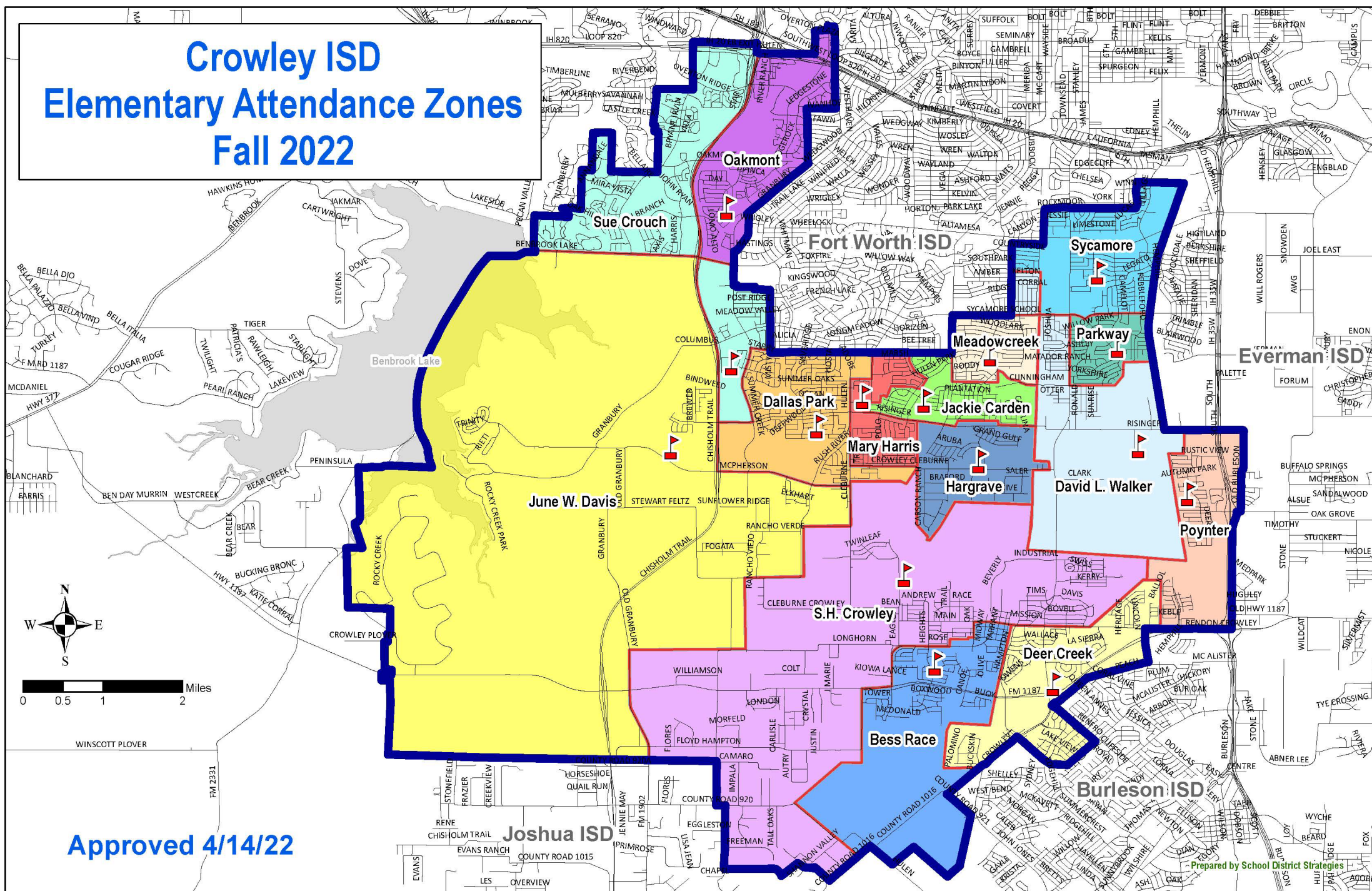

Approved 4/14/22

Crowley ISD Proposed Elementary Attendance Zones Fall 2024

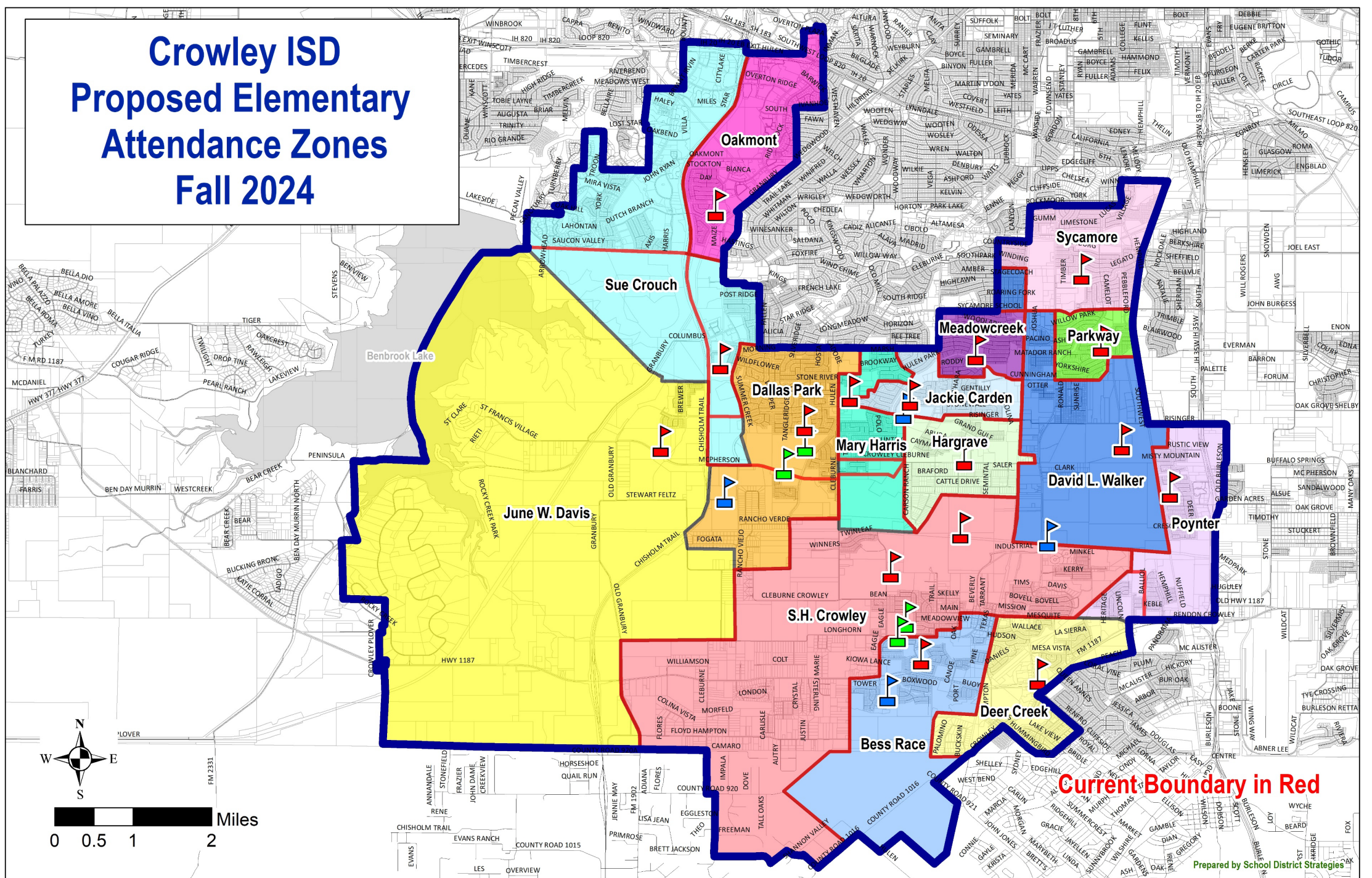

Current Boundary in Red

Crowley ISD Proposed Elementary Attendance Zones Fall 2024

1. Tavolo Park and The Chisholm at Tavolo Park Apartments move from Davis to Sue Crouch

2. Cortland Chisholm Trail Apts., Trails at Summer Creek Apts., Cottages at Summer Creek and future Villas at Summer Creek move from Dallas Park to Sue Crouch

3. CTR East, McPherson Village, Panther Heights, Woodland Springs, Deer Creek, and parts of Summer Creek Ranch move from Davis to Dallas Park

4. Future Terra Trace subdivision moves from SH Crowley to Mary Harris

5. Wellington Point subdivision moves from Dallas Park to Mary Harris

6. Centennial Place and Edgewood subdivisions move from Deer Creek to Poynter

Current Boundary in Red

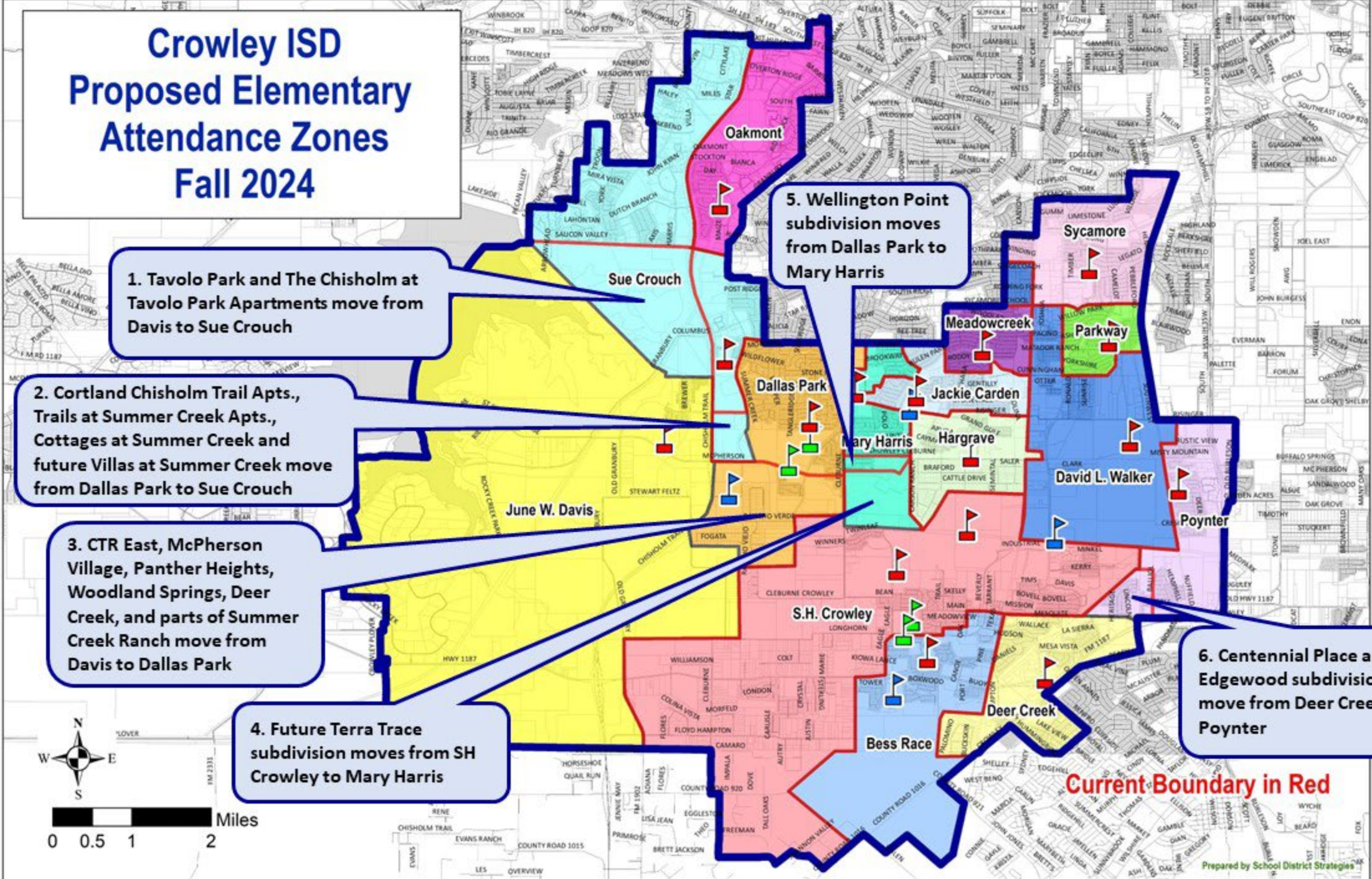
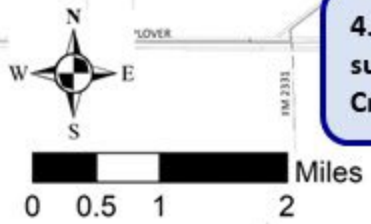

Crowley ISD Proposed Elementary Attendance Zones Fall 2025

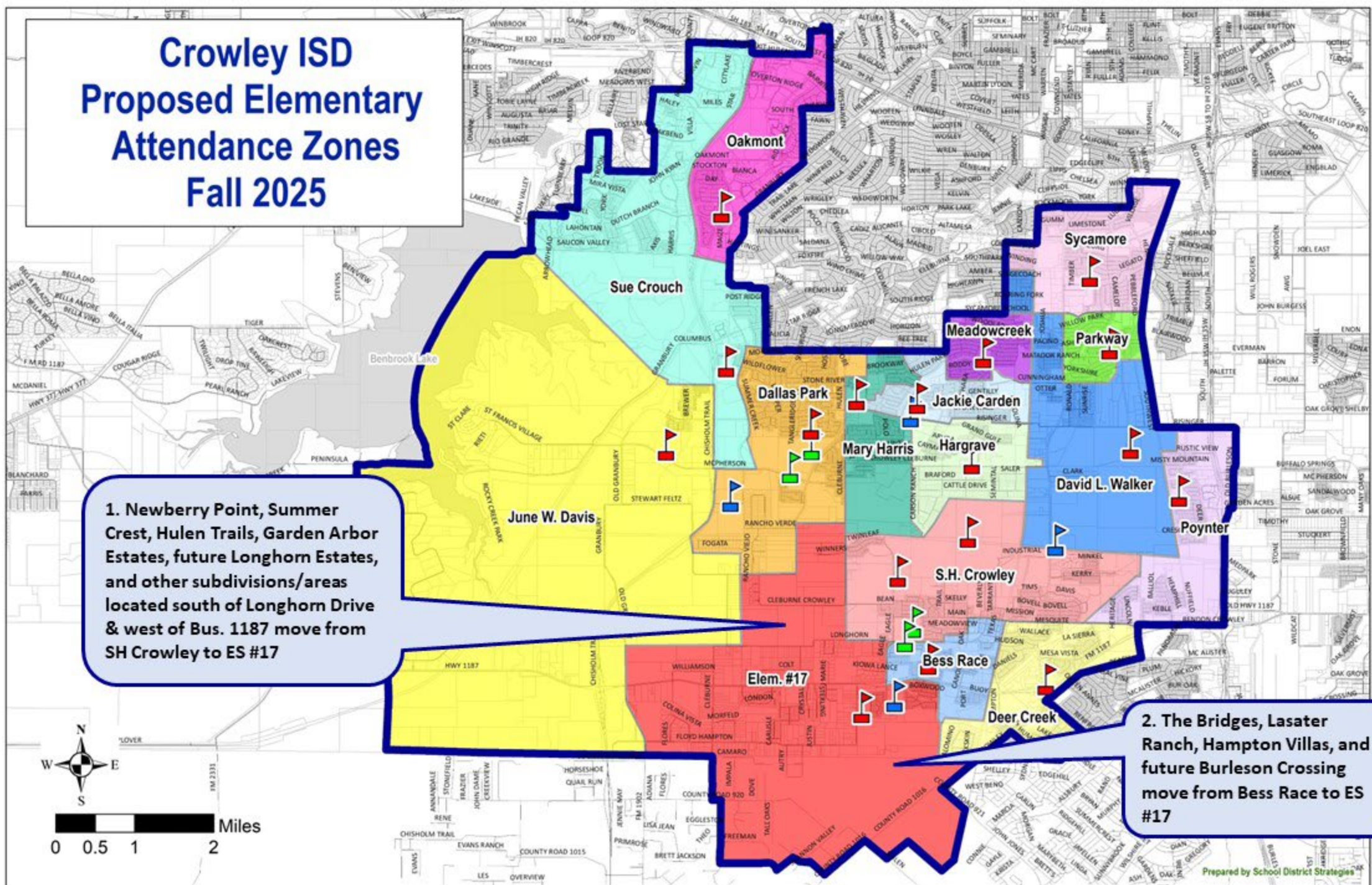

1. Newberry Point, Summer Crest, Hulen Trails, Garden Arbor Estates, future Longhorn Estates, and other subdivisions/areas located south of Longhorn Drive & west of Bus. 1187 move from SH Crowley to ES #17

2. The Bridges, Lasater Ranch, Hampton Villas, and future Burleson Crossing move from Bess Race to ES #17

Next Steps and Important Dates

What if I want to request for my child to stay at their current campus?

Two-Step Process

1. Submit Transfer Interest Form

www.tinyurl.com/transferinterest

2. Submit Transfer Request

(Allow 10 business days for response)

Important Dates

March 28

School Board Consideration and Possible Action on Rezoning

April 15

Transfer Interest Form Due

May 13-26

Transfer Request Window Open

ELEMENTARY

Attendance Boundaries



Questions? Please contact your child's principal or email studenttransfers@crowley.k12.tx.us
Visit www.crowleyisdtx.org/rezoning for updates

Current Boundary in Red